

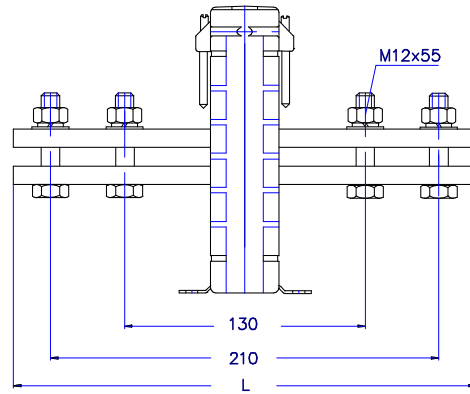

## PRIMARY BARS ( Cu E )

Primary bars produced from CuE with connection holes according to DIN 43673.

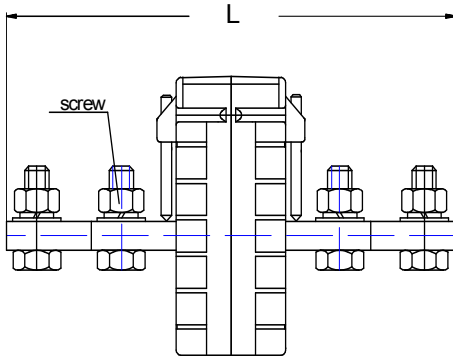

1

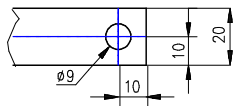

2

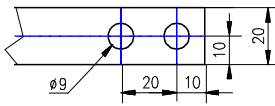

9

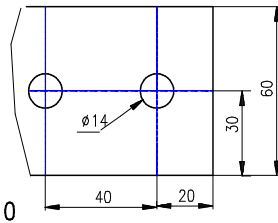

3

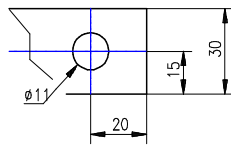

4

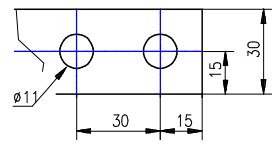

10

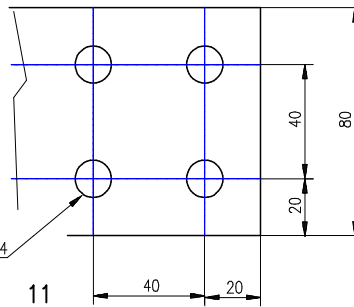

5

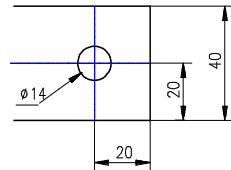

6

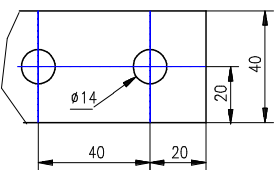

11

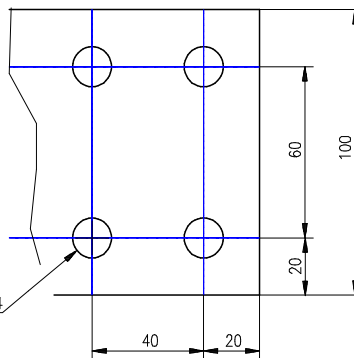

7

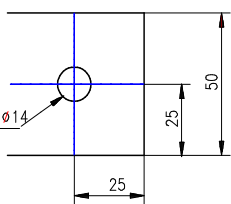

8

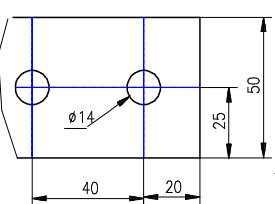

Dimensions of copper bars					
Bar dimension in mm.	No. of bars	No. of drawing	Length	Fixing screw	Max. primary current
20 x 5	1	1	100	M8x35	300
20 x 10	1	1	100		400
30 x 5	1	3	130	M10x35	400
30 x 10	1	3	150		600
40 x 5	1	5	130	M12x35	500
40 x 10	1	5	150		800
50 x 5	1	7	170		600
50 x 10	1	7	180		1000
60 x 5	1	9	240		800
60 x 10	1	9	240	1200	
80 x 5	1	10	240	1000	
80 x 10	1	10	240	1500	
100 x 10	1	11	240	2000	
50 x 10	2	8	240	M12x55	1500
60 x 10	2	9	240		2000
80 x 10	2	10	240		2500
100 x 10	2	11	240		3000
80 x 10	3	10	240		3000
Copper tubes for special mounting					
Ø8.5 x Ø14			33		300
Ø12 x Ø22.5			38		300
Ø16.5 x Ø22.5			38		600

### Special fixing for CT's with primary windings

MAK 74/WS

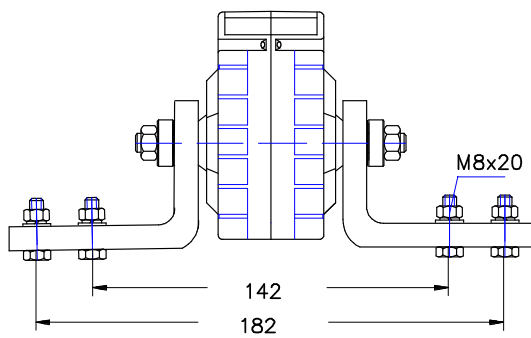

MAK 62 WS

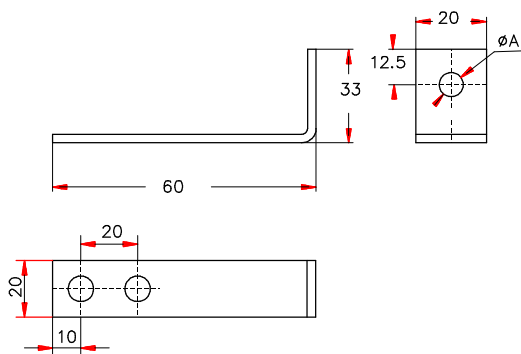
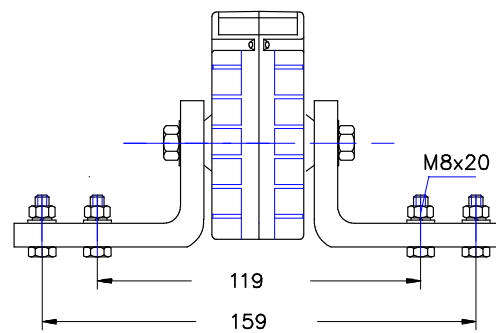

Dimensions in mm.		
Bar	ØA	L
20 x 3	7	60
20 x 3	9	60
20 x 5	11	60
20 x 5	13	60

## Clip for DIN-rail

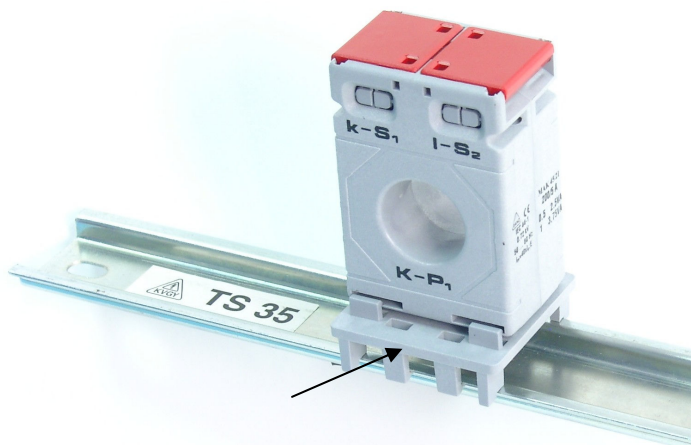

For MAK 45/14 & MAK 45/21    Cat. Nr. 12-4814-94

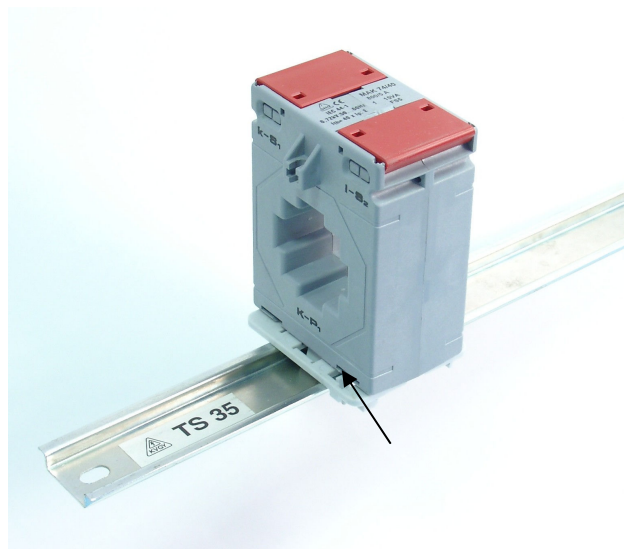

For MAK 62/20..MAK 104/80    Cat. Nr. 12-3044-94